

SWING CHECK VALVE

Cast iron swing check valve seal EPDM NP 10

Art. 085.0302



Art. 085.0302

Execution: grey cast iron body and bonnet GG 25 - nodular cast iron arm GGG 50 - stainless steel disc X20Cr14 - stainless steel pivot X20Cr13 - stainless steel seal rings X10Cr13 - EPDM seal - flanged connections UNI 2277 PN 10 - seal relief UNI 2229 - volume according to DIN 3202 series F6 normatives.

Diameters: ND 40 ÷ ND 300

Max pressure 10 bar

Max temperature 120°C

Employments: heating plants - conditioning - water supply - other fluids compatible with the construction materials .Horizontal and vertical ascending installation.

On request: execution NP 16 with stainless steel swing.

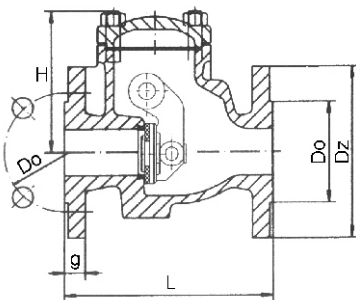

Sec.Art. 085.0302

Sizes

ND	L	H	Dz	Dp	Do	do	g	n	Weight Kg
40	180	119	150	88	110	18	18	4	9
50	200	120	165	102	125	18	20	4	11
65	240	141	185	122	145	18	20	4	15
80	260	168	200	138	160	18	22	4	20
100	300	175	220	158	180	18	24	8	31
125	350	199	250	188	210	18	26	8	46
150	400	217	285	212	240	22	26	8	60
200	500	277	340	268	295	22	30	8	120
250	600	337	405	320	355	26	32	12	180
300	700	374	460	378	410	26	32	12	250

