

THREADED BALL VALVE

Carbon steel full bore stainless steel ball NP 16/64

Art. 037.7130

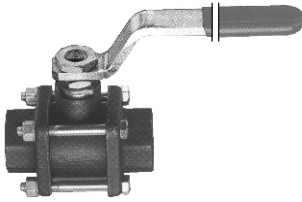

Art. 037.7130

Execution: 3 pieces construction - carbon steel body and sleeve ASTM A105 - stainless steel ball and pivot AISI 304 - PTFE carbon reinforced 25% ball gasket, washer, stem and stem gasket - viton O-ring - PVC covered steel lever - 3 pieces full bore valve - female threaded ends ISO 7/1.

Diameters: 1/4" ÷ 4"

Working pressure 16 bar ÷ 64 bar

Min temperature -20°

Max temperature 200°

Employments: hydrothermal plants.

On request: particular seals - installation of pneumatic actuator simple or double effect (see chapter "L") - electric motorization.

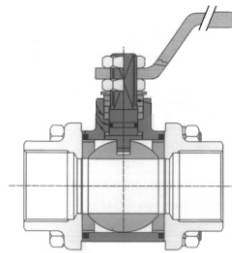

Sec.Art. 037.7130

Pressure and max temperatures

pressure steam bar	1	2	3	4	5	6	7	8	9	10	11	12	13	14	15
Temp. Steam °C	100	120	133	143	152	158	165	170	175	180	184	188	191	195	198

Sizes

Ø	I1	I2	L	H	R	P	A	C	T	KV	PN
1/4"	20.5	10	65	38	131.5	64	47	15	10	5.4	64
3/8"	20.5	11.4	65	38	131.5	64	47	15	10	6	64
1/2"	20.5	15	65	38	131.5	64	47	15	10	16.3	64
3/4"	22.5	16.3	76	46.5	131.5	68	51.5	15	10	29.5	40
1"	27	19.1	92	58	174.5	78	60	19.5	13	43	40
1L"	30	21.4	106.5	66.5	174.5	83	64.5	19.5	13	89	25
1"	31	21.4	116	76	250.5	99.5	77.5	23	15.5	230	25
2"	36	25.7	136	90	250.5	107	85	23	15.5	265	25
2"	38.5	30.2	153.5	134	321.5	126.5	103	28	18	540	16
3"	43	33.3	180	161	321.5	137.5	114	28	18	873	16
4"	50	39.3	217	190	381.5	156.5	137	34.5	22	1390	16

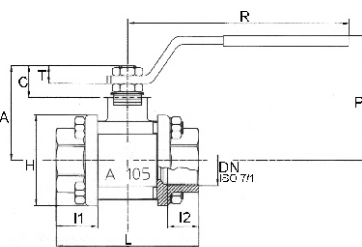

Sec.Art. 037.7130

