

ELBOW

ISO steel welded elbow

Art. 029.0620 3D - 90° DIN 2605

Art. 029.0622 3D - 180° DIN 2605

Execution: produced from ST 37.0 R DIN 1626 steel welded pipe - welding factor V=1 - 100% non-destructive test welding bead - B testing class - manufacturing, execution and tolerances according to DIN 2605 3D - smooth edges up to De 193,7 / featheredge from De 219,1.

On request: 5D radius execution - certifications according to EN 10204-DIN 50049 normatives - tests according to R.I.N.a and TUV normatives.

Dimensions

Ø	Thickness mm	Dima 3 ISO		
		r mm	90° Kg	180° Kg
26.9	2.3	29	0.06	0.12
33.7	2.6	38	0.12	0.24
42.4	2.6	48	0.19	0.38
44.5	2.6	51	0.22	0.44
48.3	2.6	57	0.26	0.52
60.3	2.9	76	0.49	0.98
63.5	2.9	83	0.56	1.12
76.1	2.9	95	0.78	1.56
82.5	3.2	108	1.06	2.12
88.9	3.2	114	1.22	2.44
101.6	3.6	134	1.83	3.66
108	3.6	143	2.08	4.16
114.3	3.6	152	2.36	4.72
133	4.0	181	3.62	7.24
139.7	4.0	190	4.00	8.00
159	4.5	216	5.80	11.60
168.3	4.5	229	6.50	13.00
193.7	5.6	270	11.00	22.00
219.1	6.3	305	15.80	31.60
273	6.3	381	24.80	49.60
323.9	7.1	457	39.80	79.60

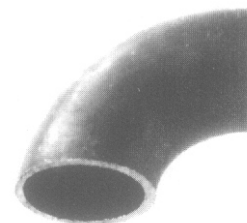
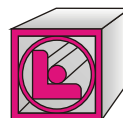

Art. 029.0620

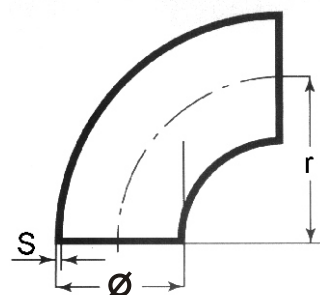

Sec.Art. 029.0620

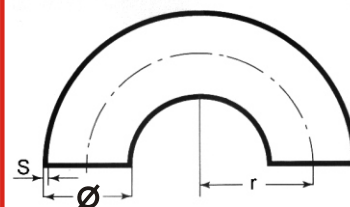

Sec.Art. 029.0622

